



**BESTBAR**

# PRODUCT GUIDE



# REINFORCE AUSTRALIAN CONCRETE ON PROGRAM, IN TIME.

Late reinforcement deliveries and lengthy load times can cause frustrating, costly delays.

We focus on providing you with accredited reinforcing products to maximise your slab pours, so more building is done with less cost overruns.



# TABLE OF CONTENTS

---

06	Locations
07	Rebar
13	Mesh
17	Accessories

---

# LOCATIONS

We maintain a strong presence across Australia, ensuring deliveries cover all regions to meet your project demands promptly.



## Perth

---

### East Rockingham (Head Office)

2 Venture Place  
East Rockingham  
WA, 6168

E | [wa.sales@bestbar.com.au](mailto:wa.sales@bestbar.com.au)  
T | (08) 9411 9300

### Wangara

100 Callaway St  
Wangara  
WA, 6065

E | [wa.sales@bestbar.com.au](mailto:wa.sales@bestbar.com.au)  
T | (08) 9411 9342

## Darwin

---

### Winnellie

6 Sadgroves Crescent  
Winnellie  
NT, 0820

Postal Address:  
PO Box 36121,  
Winnellie  
NT, 0821

E | [nt.sales@bestbar.com.au](mailto:nt.sales@bestbar.com.au)  
T | (08) 8942 9900

## Melbourne

---

### Truganina

1-3 Distribution Drive  
Truganina  
VIC, 3029

E | [vic.sales@bestbar.com.au](mailto:vic.sales@bestbar.com.au)  
T | (03) 9394 5800

### Keysborough

94 Indian Drive  
Keysborough  
VIC, 3173

E | [vic.sales@bestbar.com.au](mailto:vic.sales@bestbar.com.au)  
T | (03) 9394 5836

### Somerton

8 Newton Drive  
Somerton  
VIC, 3062

E | [vic.sales@bestbar.com.au](mailto:vic.sales@bestbar.com.au)  
T | (03) 9394 5885

## Sydney

---

### Prestons

Building 2, 43-47 Lyn Parade  
Prestons  
NSW, 2170

E | [nsw.sales@bestbar.com.au](mailto:nsw.sales@bestbar.com.au)  
T | (02) 9607 1555

### Ingleburn

2/7 Williamson Road  
Ingleburn  
NSW, 2565

E | [nsw.sales@bestbar.com.au](mailto:nsw.sales@bestbar.com.au)  
T | (02) 9607 1555

## Adelaide

---

### Pooraka

35-37 Maxwell Road  
Pooraka  
SA, 5095

Postal Address:  
PO Box 567,  
Ingle Farm  
SA, 5098

E | [sa.sales@bestbar.com.au](mailto:sa.sales@bestbar.com.au)  
T | (08) 8161 4200



# REBAR



**ENHANCE THE DURABILITY AND STRUCTURAL STRENGTH OF YOUR CONCRETE WITH OUR SELECTION OF AUSTRALIAN CERTIFIED REINFORCING BARS.**

---

Our ACRS certified rebars ensure quality products are fixed into your concrete. We stock a range of deformed and round rebar ("N"/D500) available in black and galvanized, dowels, starter bars, corner bars and pool steel (D250) to suit your next application.

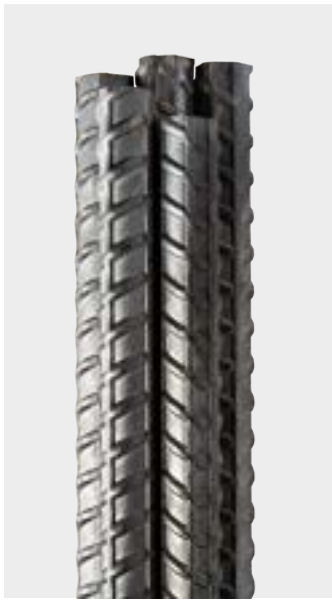

# DEFORMED REBAR

Grade N deformed reinforcing bar is used to increase tensile strength in various concrete applications.

Our Australian certified deformed reinforcing bar is available in a range of stock lengths and gauge diameters. It is commonly stocked in 6 and 12 meter lengths with diameters ranging from 10mm to 40mm.

Code	Diameter	Length (mm)	Mass (kg/m)
N10	10	6000, 9000, 12000	0.66
N12	12	6000, 9000, 12000	0.928
N16	16	6000, 9000, 12000	1.649
N20	20	6000, 9000, 12000	2.577
N24	24	6000, 9000, 12000	3.711
N28	28	6000, 9000, 12000	5.051
N32	32	6000, 9000, 12000	6.597
N36	36	6000, 9000, 12000	8.350
N40	40	6000, 9000, 12000	10.309

## SIZE GUIDE

This is a reference guide ONLY, ribs and bar marks shown here alter the size out the diameter.

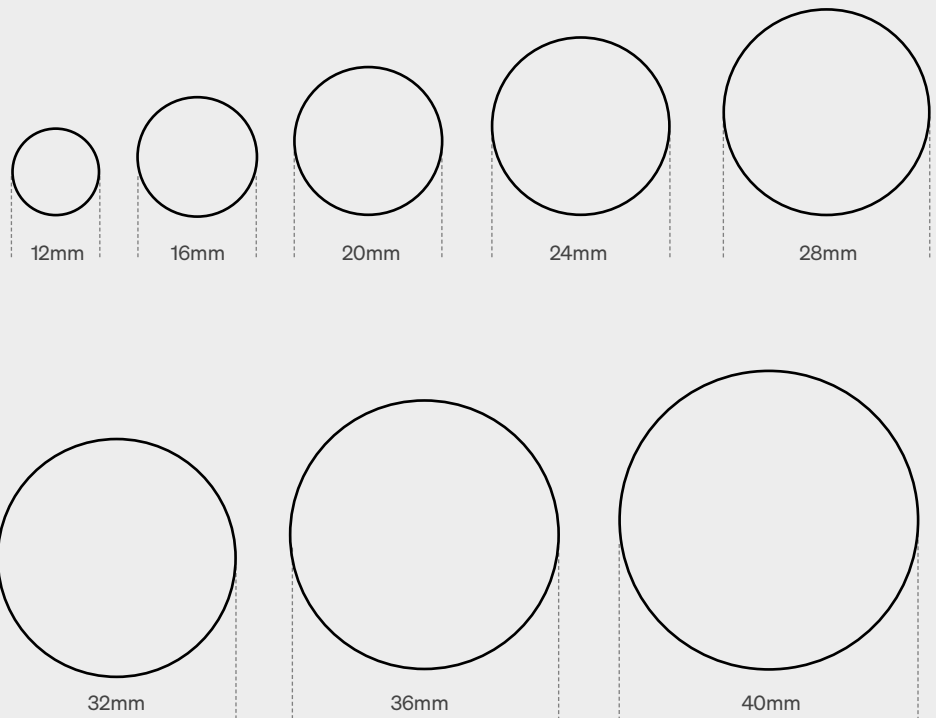
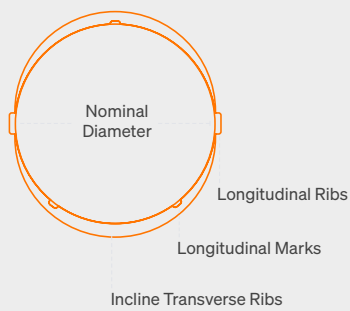



## ROUND REBAR

Round rebar is N250 grade reinforcing bar which is commonly used throughout residential, commercial and civil projects.

Code	Diameter	Length (mm)	Mass (kg/m)
R10	10	6000, 9000, 12000	0.66
R12	12	6000, 9000, 12000	0.928
R16	16	6000, 9000, 12000	1.649
R20	20	6000, 9000, 12000	2.577
R24	24	6000, 9000, 12000	3.711
R28	28	6000, 9000, 12000	5.051
R32	32	6000, 9000, 12000	6.597
R36	36	6000, 9000, 12000	8.350
R40	40	6000, 9000, 12000	

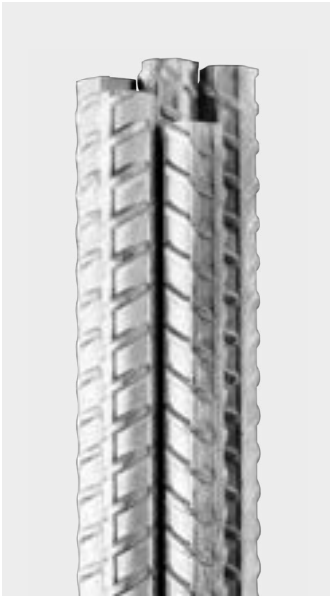

## GALVANISED REBAR

Galvanised rebar uses a protective zinc coating which prevents elements from corroding the bar. Galvanised rebar has been proven to be reliable in its resistance toward both natural and chemical corrosion.

Code	Diameter	Length (mm)
N10	10	6000, 9000, 12000
N12	12	6000, 9000, 12000
N16	16	6000, 9000, 12000
N20	20	6000, 9000, 12000
N24	24	6000, 9000, 12000
N28	28	6000, 9000, 12000
N32	32	6000, 9000, 12000
N36	36	6000, 9000, 12000
N40	40	6000, 9000, 12000



### Quality Assurance

All Reinforcing bar is ACRS certified and complies with AS/NZS 4671



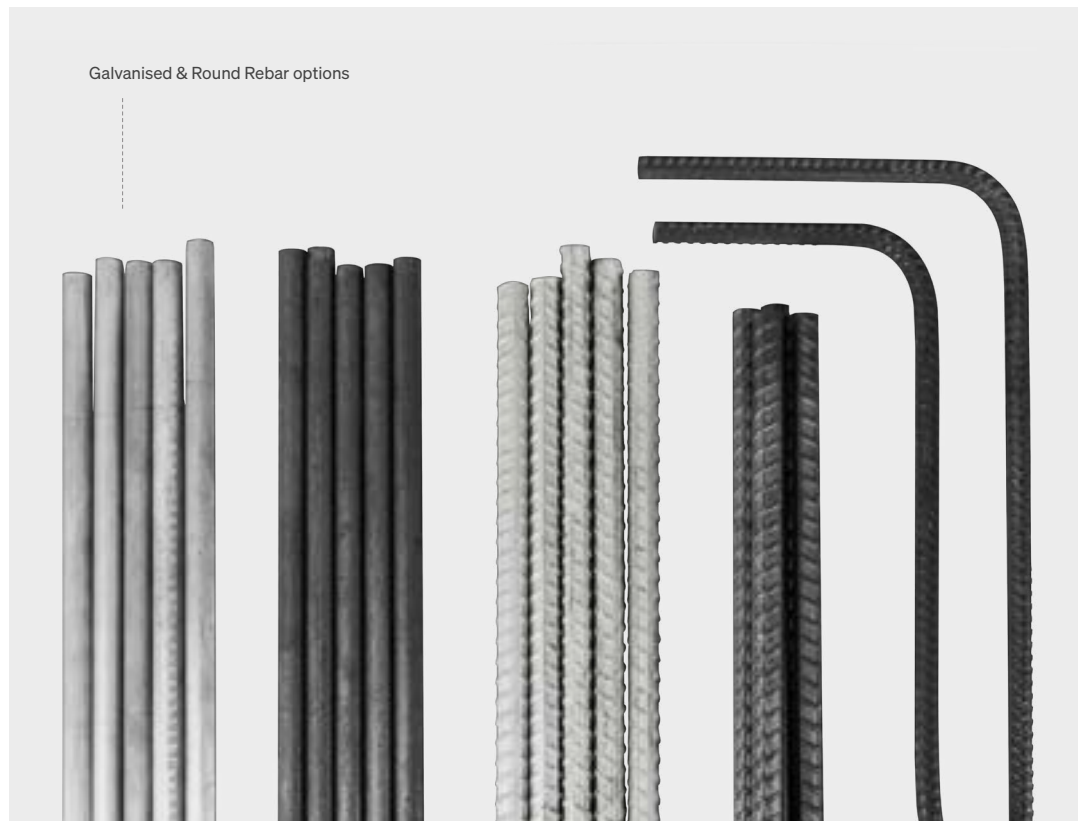

## STOCK REBAR

Throughout each state, we stock a combination of ACRS certified starter bars, corner bars, z bars, re-entry bars and ligatures in a range of shapes, sizes and gauge diameters. All locations across Australia can also cut/bend and fabricate rebar to suit specific project requirements.

### SHAPE GUIDE

—  
Please contact your local Bestbar representative for more information and their full stocked rebar range.

For the complete list of 150+ shapes [click here](#)

#### RE- ENTRY BARS

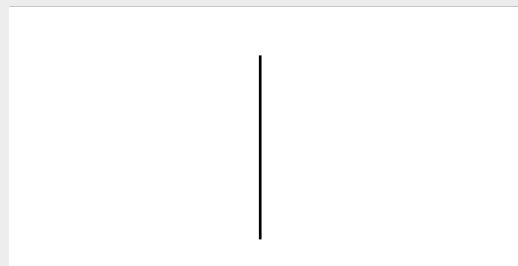

#### STARTER BARS

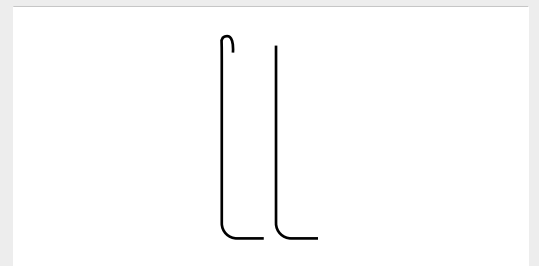

#### CORNER BARS

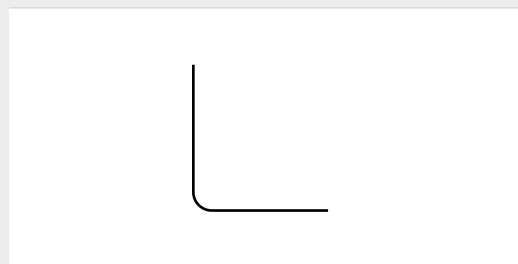

#### Z BARS

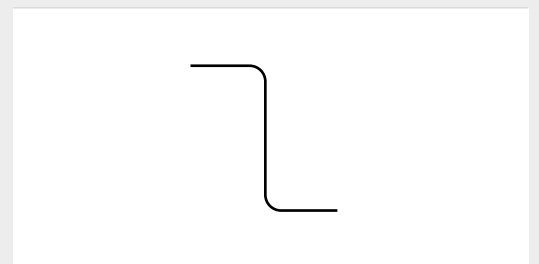



# MESH



**OUR REINFORCING MESH RANGE  
CAN BE USED TO FACILITATE ALL  
YOUR CONCRETE SLAB PROJECTS  
COST-EFFECTIVELY.**

---

Our selection of ACRS certified mesh products include: square, rectangular, trench and galvanised. Choose from our stock sizes or opt for custom-cut solutions to fit your requirements.

# SQUARE MESH

Square reinforcing mesh is manufactured from L grade ACRS certified ribbed wires, to strengthen concrete slabs.

Square mesh is a general purpose mesh used in a variety of concrete applications; including walls, precast panels, house slabs, driveway slabs and is stocked in two standard sizes: 6m x 2.4m and 3m x 2.4m.

Code	Unit	Long Wire (mm)	Cross Wire (mm)	Weight (kg)
SL62	Sheet	6 @ 200	6 @ 200	33
SL72	Sheet	6.75 @ 200	6.75 @ 200	40.79
SL82	Sheet	8 @ 200	8 @ 200	52.32
SL92	Sheet	8.6 @ 200	8.6 @ 200	65.52
SL41	Sheet	4 @ 100	4 @ 100	29
SL102	Sheet	10 @ 200	10 @ 200	80.27
SL81	Sheet	8 @ 100	8 @ 100	104.66
SL63	Sheet	6 @ 300	6 @ 300	21.9
SL53	Sheet	4.75 @ 300	4.75 @ 300	15
SL52	Sheet	4.75 @ 200	4.75 @ 200	22

## FULL SHEET

6m Length  
2.4m Width

## HALF SHEET

3m Length  
2.4m Width

Stocked square and rectangular mesh sheet sizes around Australia

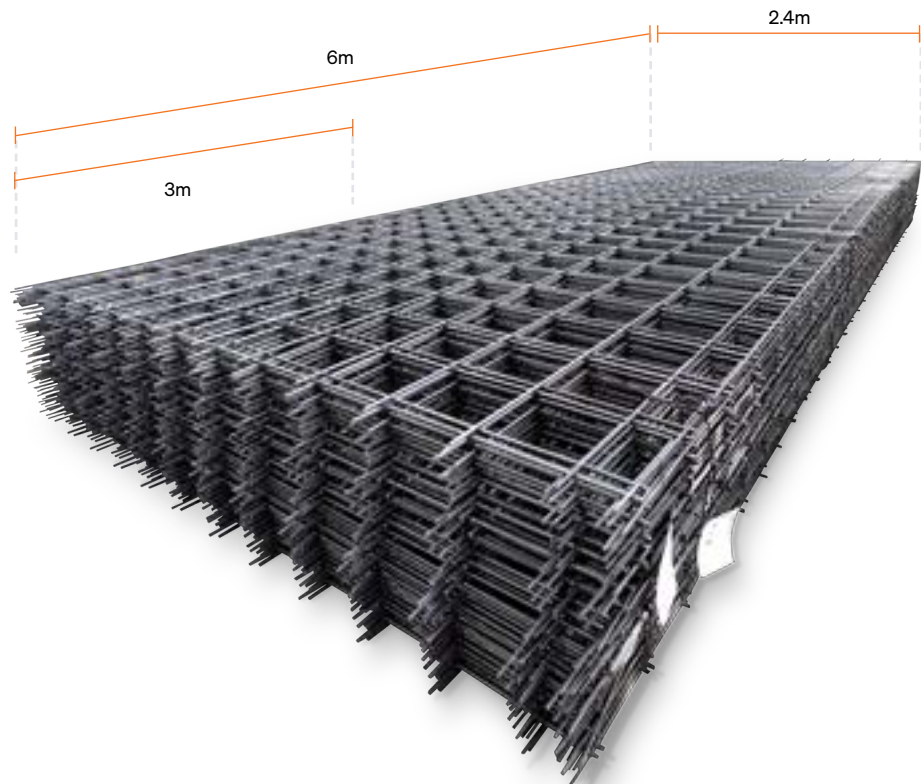

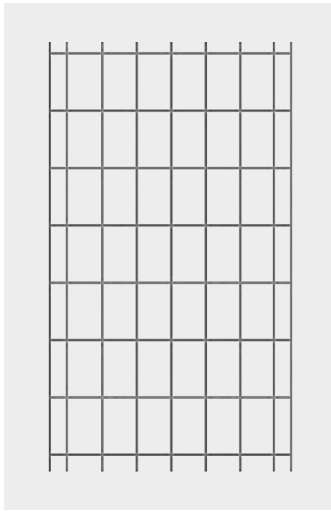

## RECTANGULAR MESH

Rectangular reinforcing mesh is for projects that require higher tensile stability to maximise concrete strength in one direction.

Code	Unit	Long Wire (mm)	Cross Wire (mm)	Weight (kg)
RL718	Sheet	6.75 @ 100	7.6 @ 200	67.78
RL818	Sheet	8 @ 100	8 @ 200	79.03
RL918	Sheet	8.6 @ 100	7.6 @ 200	94.03
RL1018	Sheet	10 @ 100	8 @ 200	109.18
RL1118	Sheet	11 @ 100	8 @ 100	131.53
RL1218	Sheet	12.5 @ 100	8 @ 200	156.58

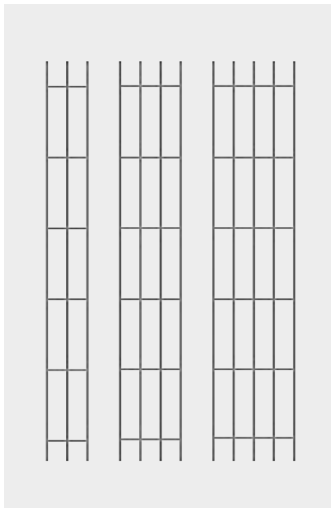

## TRENCH MESH

Trench mesh is a Class L reinforcing mesh used in residential, industrial and commercial buildings to reinforce concrete footings and beams.

Code	Unit	Long Wire (mm)	Cross Wire (mm)	Weight (kg)
L8TM3	Sheet	7.6 @ 100	4.75 @ 300	7.05
L8TM4	Sheet	7.6 @ 100	4.75 @ 300	9.49
L8TM5	Sheet	7.6 @ 100	4.75 @ 300	11.94
L11TM3	Sheet	10.7 @ 100	4.75 @ 300	13.36
L11TM4	Sheet	10.7 @ 100	4.75 @ 300	17.89
L11TM5	Sheet	10.7 @ 100	4.75 @ 300	22.44
L11TM6	Sheet	7.6 @ 100	4.75 @ 300	26.99
L12TM3	Sheet	11.9 @ 100	4.75 @ 300	16.36
L12TM4	Sheet	11.9 @ 100	4.75 @ 300	21.9
L12TM5	Sheet	11.9 @ 100	4.75 @ 300	27.45



### Quality Assurance

All mesh wire is ACRS certified and complies with AS/NZS 4671



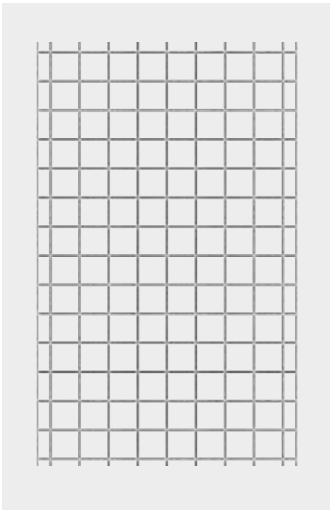

## GALVANISED MESH

Galvanised mesh uses a protective zinc coating which prevents elements from corroding the mesh. Galvanised mesh has been proven to be reliable in its resistance toward both natural and chemical corrosion.

Code	Unit	Long Wire (mm)	Cross Wire (mm)	Weight (kg)
SL62	Sheet	6 @ 200	6 @ 200	33
SL72	Sheet	6.75 @ 200	6.75 @ 200	40.79
SL82	Sheet	8 @ 200	8 @ 200	52.32
SL92	Sheet	8.6 @ 200	8.6 @ 200	65.52
SL41	Sheet	4 @ 100	4 @ 100	29
SL102	Sheet	10 @ 200	10 @ 200	80.27
SL81	Sheet	8 @ 100	8 @ 100	104.66
SL63	Sheet	6 @ 300	6 @ 300	21.9

24

# DELIVERY WITHIN 24 HOURS\*

—  
Australia wide delivery on  
stock reinforcing products  
so you can get your slabs  
poured on time.



# ACCESSORIES

A close-up, black and white photograph of various metal reinforcing accessories. The focus is on a mesh chair, which is a U-shaped metal component used to support rebar in concrete. Other similar components are visible in the background, some slightly out of focus.

**PAIR YOUR MESH AND REBAR  
WITH RELIABLE REINFORCING  
ACCESSORIES TO SUPPORT YOUR  
CONCRETE FOUNDATIONS.**

---

Concrete jobs require a variety of accessories including combination mesh chairs, rebar chairs, spacers, bar guards, tie wire and additional building accessories. We can help you choose the most effective products for your application.



## CONCRETE BLOCKS

40MPa Concrete Spacers

Code	Description	Unit Qty
CB653	Concrete Blocks 65mm x 50mm x 32mm	50
CB654	Concrete Blocks 60mm x 50mm x 40mm	50
CB754	Concrete Blocks 75mm x 50mm x 40mm	40
CB765	Concrete Blocks 75mm x 65mm x 50mm	25
CB777	Concrete Blocks 75mm x 75mm x 75mm	15
CB1077	Concrete Blocks 100mm x 75mm x 75mm	10
CB1119	Concrete Blocks 115mm x 100mm x 90mm	5



## CONCRETE BLOCKS

50 MPa Wired Concrete Spacers

Code	Description	Unit Qty
ASPRO40	60mpa Block 40mm X 50mm X 50mm With Galv Tie	50
ASPRO50	60mpa Block 60mm X 50mm X 50mm With Galv Tie	50
ASPRO60	60mpa Block 65mm X 50mm X 50mm With Galv Tie	25
ASPRO65	60mpa Block 65mm X 50mm X 50mm With Galv Tie	25
ASPRO70	60mpa Block 70mm X 60mm X 60mm With Galv Tie	25
ASPRO75	60mpa Block 75mm X 60mm X 60mm With Galv Tie	20
ASPRO100	60mpa Block 100mm X 60mm X 60mm With Galv Tie	15



## TIE WIRE

Made from annealed steel wire and is primarily used for tying and binding reinforcement bars and mesh

Code	Description	Unit Qty
HC	Black Handy Coil - 1.4mm Wire	1
HC16	Black Handy Coil - 1.6mm Wire	1
TW25	Black Tie Wire, 20kg Roll - 2.5mm Wire	1
HC-16GALV	Galvanised Handy Coil - 1.6mm Wire	1





# WIRE BAR CHAIRS WITH PLASTIC TIPS

For suspended slabs, beams, vertical walls and slabs on ground application

Code	Description	Unit Qty
MC20	Plastic Tipped Wire Bar Chairs - 20mm	100
MC25	Plastic Tipped Wire Bar Chairs - 25mm	100
MC30	Plastic Tipped Wire Bar Chairs - 30mm	100
MC40	Plastic Tipped Wire Bar Chairs - 40mm	100
MC50	Plastic Tipped Wire Bar Chairs - 50mm	100
MC65	Plastic Tipped Wire Bar Chairs - 65mm	100
MC75	Plastic Tipped Wire Bar Chairs - 75mm	100
MC90	Plastic Tipped Wire Bar Chairs - 90mm	100
MC100	Plastic Tipped Wire Bar Chairs - 100mm	100
MC110	Plastic Tipped Wire Bar Chairs - 110mm	100
MC120	Plastic Tipped Wire Bar Chairs - 120mm	100
MC130	Plastic Tipped Wire Bar Chairs - 130mm	100
MC140	Plastic Tipped Wire Bar Chairs - 140mm	50
MC150	Plastic Tipped Wire Bar Chairs - 150mm	50
MC160	Plastic Tipped Wire Bar Chairs - 160mm	50
MC170	Plastic Tipped Wire Bar Chairs - 170mm	50
MC180	Plastic Tipped Wire Bar Chairs - 180mm	50
MC190	Plastic Tipped Wire Bar Chairs - 190mm	50
MC200	Plastic Tipped Wire Bar Chairs - 200mm	50
MC210	Plastic Tipped Wire Bar Chairs - 210mm	50
MC220	Plastic Tipped Wire Bar Chairs - 220mm	50
MC230	Plastic Tipped Wire Bar Chairs - 230mm	50
MC240	Plastic Tipped Wire Bar Chairs - 240mm	50
MC250	Plastic Tipped Wire Bar Chairs - 250mm	50
MC260	Plastic Tipped Wire Bar Chairs - 260mm	50
MC270	Plastic Tipped Wire Bar Chairs - 270mm	50
MC280	Plastic Tipped Wire Bar Chairs - 280mm	50
MC290	Plastic Tipped Wire Bar Chairs - 290mm	50
MC300	Plastic Tipped Wire Bar Chairs - 300mm	50





## BASE PLATES

To support wire bar chairs on soft surfaces

Code	Description	Unit Qty
TIN LIDS	Metal Base Plates - 230mm	50

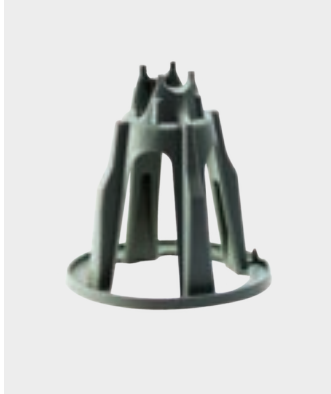

## COMBINATION BAR CHAIRS

For slab on ground, strip footings and light pad footings

Code	Description	Unit Qty
COM2025	Plastic Combination Chairs 20mm x 25mm	100
COM2540	Plastic Combination Chairs 25mm x 40mm	100
COM5065	Plastic Combination Chairs 50mm x 65mm	100
COM7590	Plastic Combination Chairs 75mm x 90mm	100
COM85100	Plastic Combination Chairs 85mm x 100mm	100



## CLIP-ON BAR CHAIRS

For precast and tilt-up, suspended decks, beams, walls & panels

Code	Description	Unit Qty
PCB20	20mm Clip-On Bar Chair For 4-20mm Bar	100
PCB25	25mm Clip-On Bar Chair For 4-20mm Bar	100
PCB30	30mm Clip-On Bar Chair For 4-20mm Bar	100
PCB35	35mm Clip-On Bar Chair For 4-20mm Bar	100
PCB40	40mm Clip-On Bar Chair For 4-20mm Bar	100
PCB50	50mm Clip-On Bar Chair For 4-20mm Bar	100
PCB60	60mm Clip-On Bar Chair For 4-20mm Bar	100
PCB65	65mm Clip-On Bar Chair For 4-20mm Bar	100
PCB75	75mm Clip-On Bar Chair For 4-20mm Bar	100







## CLIP-ON BAR CHAIRS-HEAVY DUTY

For civil heavy precast, horizontal or vertical suspended decks, bar or mesh, precast beams, strip footings with base and insitu beams

Code	Description	Unit Qty
PCBL30	30mm Clip-On Bar Chair (Large) For 20-36mm Bar	100
PCBL40	40mm Clip-On Bar Chair (Large) For 20-36mm Bar	100
PCBL50	50mm Clip-On Bar Chair (Large) For 20-36mm Bar	100
PCBL65	65mm Clip-On Bar Chair (Large) For 20-36mm Bar	100
PCBL75	75mm Clip-On Bar Chair (Large) For 20-36mm Bar	100



## CLIP-ON MESH CHAIRS

Code	Description	Unit Qty
PCM20	20mm Clip-on Mesh Chair	100
PCM25	25mm Clip-on Mesh Chair	100
PCM30	30mm Clip-on Mesh Chair	100
PCM40	40mm Clip-on Mesh Chair	100
PCM50	50mm Clip-on Mesh Chair	100
PCM65	65mm Clip-on Mesh Chair	100
PCM75	75mm Clip-on Mesh Chair	100



## SLAB ON GROUND CHAIRS

Code	Description	Unit Qty
SOG110	110mm Slab on Ground Chair	100
SOG120	120mm Slab on Ground Chair	100
SOG130	130mm Slab on Ground Chair	100
SOG140	140mm Slab on Ground Chair	100
SOG150	150mm Slab on Ground Chair	100



## BOTTEM DECK SPACERS

For suspended decks, beams, tilt-up panels, precast panels, beams and blinding concrete

Code	Description	Unit Qty
BPDS15/20	15mm x 20mm Plastic Bottom Deck Spacer	100
BPDS25/30	25mm x 30mm Plastic Bottom Deck Space	100
BPDS35/40	35mm x 40mm Plastic Bottom Deck Spacer	100
BPDS45/50	45mm x 50mm Plastic Bottom Deck Spacer	100



## TOP DECK SPACERS

Code	Description	Unit Qty
BPDST65/75	65mm x 75mm Plastic Top Deck Spacer	50
BPDST90/100	90mm x 100mm Plastic Top Deck Spacer	50
BPDST110/120	110mm x 120mm Plastic Top Deck Spacer	50
BPDST130/140	130mm x 140mm Plastic Top Deck Spacer	50
BPDST150/160	150mm x 160mm Plastic Top Deck Spacer	50
BPDST170/180	170mm x 180mm Plastic Top Deck Spacer	50
BPDST190/200	190mm x 200mm Plastic Top Deck Spacer	50



